

**SpotNRG**  
**Evesta Caladrius S**  
**Three-phase DIN rail Wi-Fi relay**  
**Instructions for installation and use**

**GENERAL**

This manual describes the main functions and technical characteristics of the Wi-Fi three-phase relay. These instructions will help the user to control the Wi-Fi relay, and the electrician to install the relay.

**SPECIFICATIONS**

- Voltage:** 230VAC - 50/60 Hz
- Maximum load:** 3x16A (resistive)
- Operating temperature range:** +0°C – +30°C
- Allowed pollution class for installation:** 2
- Colour:** Grey
- Standards:** CE, EN 60730-1, EN 300 328 V2.2.2
- Wi-Fi:** 2.4GHz 802.11bgn

**INSTALLATION OF THE DEVICE**

Installation should only be carried out by an authorized electrician in accordance with wiring and building regulations. During installation, the relay must be turned off or insulated ALWAYS! The relay is connected to the DIN rail in an electrical cabinet or in a separate case.

Connect the wires to the terminals of the three-phase relay:

**L1, L2, L3:** Potential-free relays

**N:** Zero

**L:** Phase (operating voltage for circuit board electronics)

**CT:** Current transformer input 1:300. Current transformer may be connected to measure current from L1

**USE WITH THE PHONE APP**

An Android or Apple phone application makes it possible to control the relay via the Internet regardless of location.

The app can be downloaded from Apple's Appstore, Google Play Store, or by using the link below.



The Wi-Fi relay is connected to the cloud service using the "Pair a DIN rail switch" function in the phone application. Press the plus icon in the upper right corner.

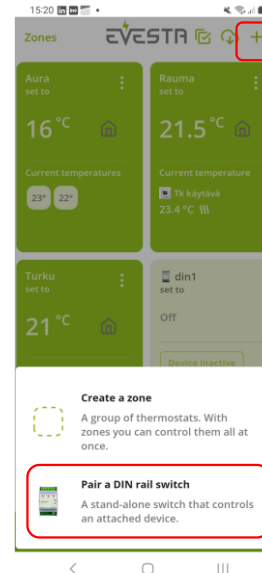

Follow the instructions provided by the phone app. The relay is put into pairing mode by pressing the "Pair" button on the relay for more than five seconds. Initially, the Wi-Fi led indicator will blink green. When the indicator starts blinking red, release the button. When the indicator turns solid green, the device is ready to be connected to the cloud using a phone application. At the same time, the relay is reset to factory settings. If the connection is not made in ten minutes, the relay will return to its original state. The rest of the settings, such as setting the network and password, as well as setting the geographical location of the relay, are made with the phone application. Location is used to select the right electricity price range.

**TECHNICAL SETTINGS**

The technical settings of the relay are made by opening the relay card from the main view of the application and pressing on the gear in the upper right corner. Technical settings are under the "Show advanced settings" menu.

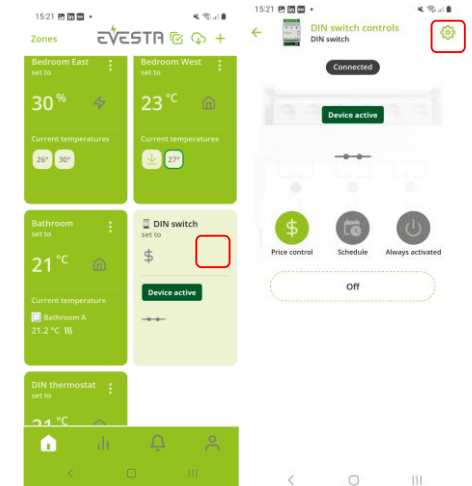

Possible technical settings are:

1. Whether the relay is activated during cheap or expensive electricity hours.
2. Whether the relay is in the active state open or closed.
3. The size of the load in Watts. This information is used to calculate energy consumption and savings.

**USER SETTINGS**

The application offers three modes of operation for the relay, price control, weekly schedule or always on.

The price control options are in the "Electricity cost optimization" menu under the gear menu. The number of relay activation hours can be set there. The weekly program is set in the "Set up schedule" menu under the gear menu. It is possible to program five entries for one day. At the entry the operation time is selected and whether the relay is active or inactive. The final polarity of the relay (switches closed or open), when the relay is activated, is selected in the "Show Advanced settings" menu.

---

## INDICATOR LEDS

LEDs at the top indicate the status of the individual internal relays. If the LED is green, the relay is closed.

Color codes for Wi-Fi LED:

*Green:* Thermostat connected to Wi-Fi and cloud.

*Blue:* The thermostat is connected to a Wi-Fi network, but the connection to the cloud is missing.

*Red:* The thermostat cannot connect to Wi-Fi.

*Led off:* Wi-Fi turned off.

*Blinking blue:* Relay in force closed state.

If the relay is in failure mode, the relay indicators are red.

## CHANGING WI-FI NETWORK

If you want to connect the relay to a different Wi-Fi network or the network password has changed, you can do so using the "Reconfigure Wi-Fi" function in the phone application. The relay is set to the "Reconfigure Wi-Fi" mode with a short press of the Pair button. This feature is enabled only if the relay was previously connected to the cloud.

If you want to add the relay as a new device and reset it to factory settings, you can do so with the long press of the Pair button, more than five seconds.

## FORCE CLOSED MODE

By pressing the "Pair" button on the relay for more than ten seconds, until the Wi-Fi indicator starts to blink blue, the relay can be set to the mode where the internal three switches are in the closed position. In this mode, the Wi-Fi indicator flashes blue. The relay will return to normal operation by pressing the "Pair" button again for more than ten seconds.

